

Courses & distances up river

- | | | | | |
|----|---|----|---|-----|
| 1. | N | 87 | E | 22. |
| 2. | S | 77 | E | 38. |
| 3. | S | 66 | E | 19. |
| 4. | S | 55 | E | 38. |
| 5. | S | 29 | E | 38. |
| 6. | S | 13 | E | 33. |
| 7. | S | 28 | W | 79. |
| 8. | S | 37 | W | 21. |
| 9. | S | 49 | W | 38. |

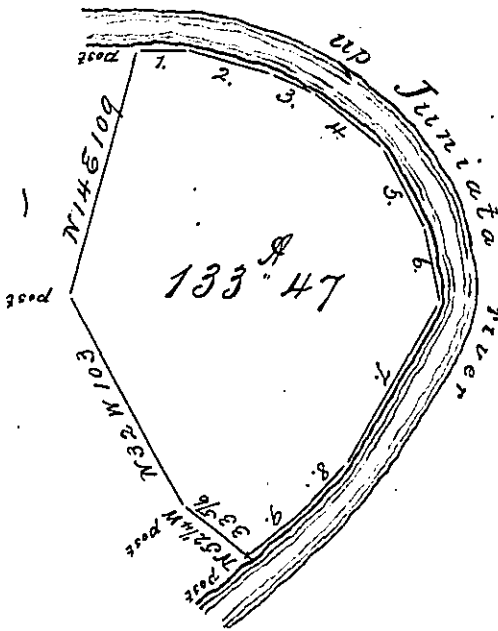

A Draft of one hundred and thirty three acres and forty seven perches of land with six per cent for roads situate in Wayne township on the north side of Juniata river in Mifflin, late Cumberland, county which appears to have been surveyed September 1763 in pursuance of a warrant to Daniel Carmichael dated 5th June 1762. Resurveyed 14th January 1815 for Joshua & William Morrisons
Examined 31st March 1823.

Robert Robison D.S.
To Samuel Cochran Esquire
Surveyor General of Pennsylvania

IN TESTIMONY that the above is a copy of the original remaining on file in the Department of Internal Affairs of Pennsylvania, made conformably to an Act of Assembly approved the 16th day of February, 1833, I have hereunto set my Hand and caused the Seal of said Department to be affixed at Harrisburg, this
Seventh day of April 1896

James W. Fatta
Secretary of Internal Affairs.